

STEP
2

Long & Short Pole Assembly

Push-Button Kit



Please inflate all balloons within 30 days of purchase to comply with Warranty Guidelines.

WHAT YOU'LL NEED

See Step ①



INFLATED BALLOON, CUP & STEM ASSEMBLY

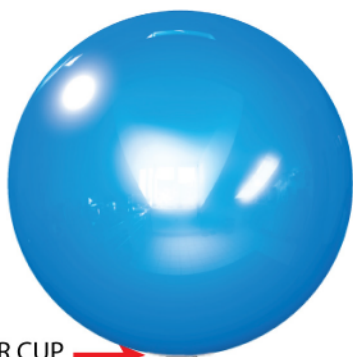

UPPER CUP →

48" Long Pole

24" Short Pole



or



IMPORTANT Complete step ① on separate card before beginning the hardware assembly steps below.

2.1

Align inflated balloon assembly with top of long/short pole and slide bottom of stem into the pole. Align push-button so that it locks into place through the hole in the pole.

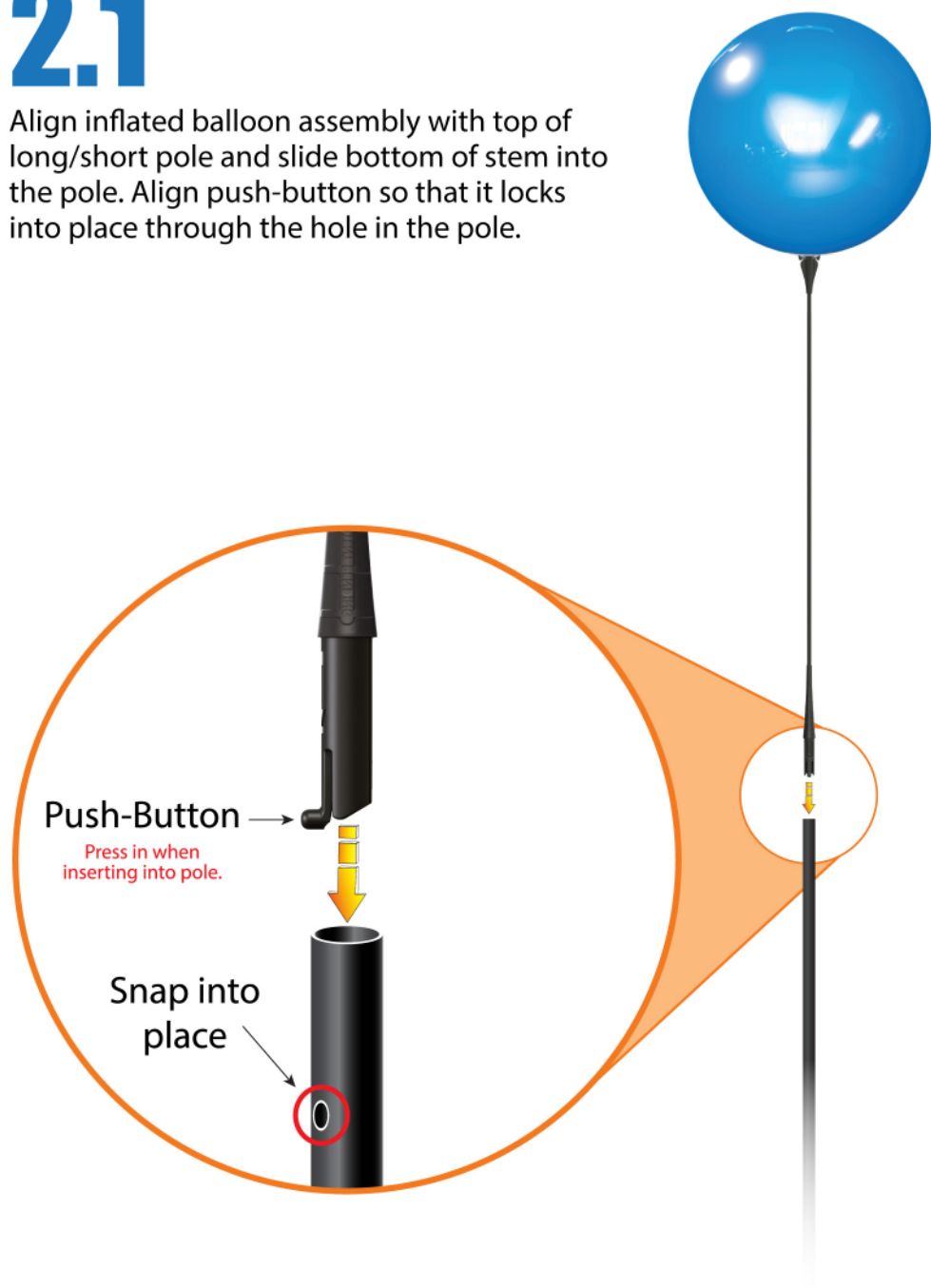

2.2

Assemble your chosen mounting option shown below using Step ③ to complete your Long/Short Pole Kit.



**STAKEMATE
GROUND PLATE**



**STAKEMATE
MEGAPLATE**

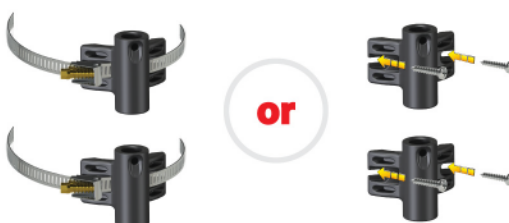

**BAND CLAMP or SCREW
POLE BRACKETS**



WEIGHTED BASE